

# MAZIC GW-1560



## Features

- Intel® Core™ / Intel® Celeron® Processor
- 15.6" Bezel-Free Display with PCAP Touch & LED Backlight
- Improved product reliability with high-qualified circuit elements
- Complete FAN Free with innovative heat pipe design (Fanless)
- Full Aluminum Die-casting Cabinet
- Completely Refined Design for MAZIC Series
- Elegant & Robust Dual Hinge (Foldable)
- Swappable System Box
- Spill and Dust Resistant
- Modernized external I/O Box for I/O extension

## Specifications

System	Processors	Intel® Core™ i5-7200U (3M Cache, 2.50/3.10 GHz(Turbo), 2 Cores) Intel® Core™ i3-7100U (3M Cache, 2.40 GHz, 2 Cores) Intel® Celeron® 3965U (2M Cache, 2.20 GHz, 2 Cores) Intel® Celeron® Processor J3455 (2M Cache, up to 2.3 GHz, 4 Cores)
	Chipset	7200U/7100U/3965U Intel® Kaby Lake J3455 Intel® Apollo Lake
	Memory	7200U/7100U/3965U 4GB Standard, DDR4 2133 MT/s, Socket 1 x SODIMM (Max. 16GB) J3455 4GB Standard, DDR3L 1600 MT/s, Socket 1 x SODIMM
	Storage	NVMe M.2 128G
	RAID	7200U/7100U RAID 0,1 (SATA Only)
	Operating Systems	Windows 10 IoT Enterprise
	Audio	HD Audio Codec
Display	Type	15.6" TFT LCD, LED Backlight
	Resolution	1366 x 768
	Brightness	400 cd/m <sup>2</sup> (typ.)
	Touchscreen	Projected Capacitive Touch, AF
Interface	Display	1 x Display port (USB-C)
	USB	5 (Rear 5, USB 3.0 x 2, USB 2.0 x 2, USB C type x 1) 3 (Reserved for MSR, SCR, i-Button/Touch Controller)
	Serial	2 (COM1 reserved MSR/SCR, TX/RX only) (COM2 reserved CDP, TX/RX only)
	Cash Drawer Port	1 x RJ-11 (Integrated circuit GPIO)
	LAN	1 x Gigabit Ethernet, RJ-45
	Audio	1 x Line-out
	Power DC-IN	USB C
Power	Power Supply	Adaptor 12V, 5A(C-Type Plug) / 24V, 6.35A (3Pin DIN Plug) (I/O BOX Option)
Physical & Environmental	Operating Temperature	0 °C ~ 60 °C at 10% to 90% Humidity
	Storage Temperature	-20 °C ~ 80 °C at 10% to 90% Humidity
	Dimensions (W x H x D)	400 x 380 x 245 (mm), 15.7 x 14.9 x 9.6(in)
	Packing Dimensions (W x H x D)	500 x 180 x 300 (mm), 19.7 x 7.1 x 11.8(in)
	Net Weight	6.1 Kg, 13.44 lb
	Packing Weight	6.7 Kg, 14.77 lb
	Certification	CE, FCC, KC
	Color	Matte Dark Black
Options & Peripherals	2nd Displays	9.7" (1024 x 768), 13.3" (1920 x 1080) LCD Display, Optional Touchscreen
	Customer Display	VFD, 20 Columns x 2 Lines
	I/O Expansion	Support I/O Expansion Box 4 x COM (2 x D-sub/COM3/COM4, 2 x RJ-45/COM5/COM6) 1 x HDMI 1 x Gigabit Ethernet, RJ-45 2 x USB 3.0 4 x USB 2.0 1 x Cash Drawer Port (RJ-11 6 Pins) 2 x Powered USB (12V/24V)
	Storage	NVMe M.2 128G
	Magnetic Stripe Reader	Comply with ISO 7811, Support 1 & 2 & 3 Track
	Smart Card Reader	EMV Level 1, 2
	Dallas	Dallas i-button Reader
	Fingerprint	Yes
	Camera	5M USB Interface (Internal) (Factory Option)
	Wall Mount Kit	VESA-Compatible, 100 x 100(mm)
	Speaker	2 x 0.7W (Stereo) (Factory Option)
	WiFi / Bluetooth	Combo Module, M.2 (Factory Option)

\* Specifications may change without prior notice.

## Dimensions

Unit : mm

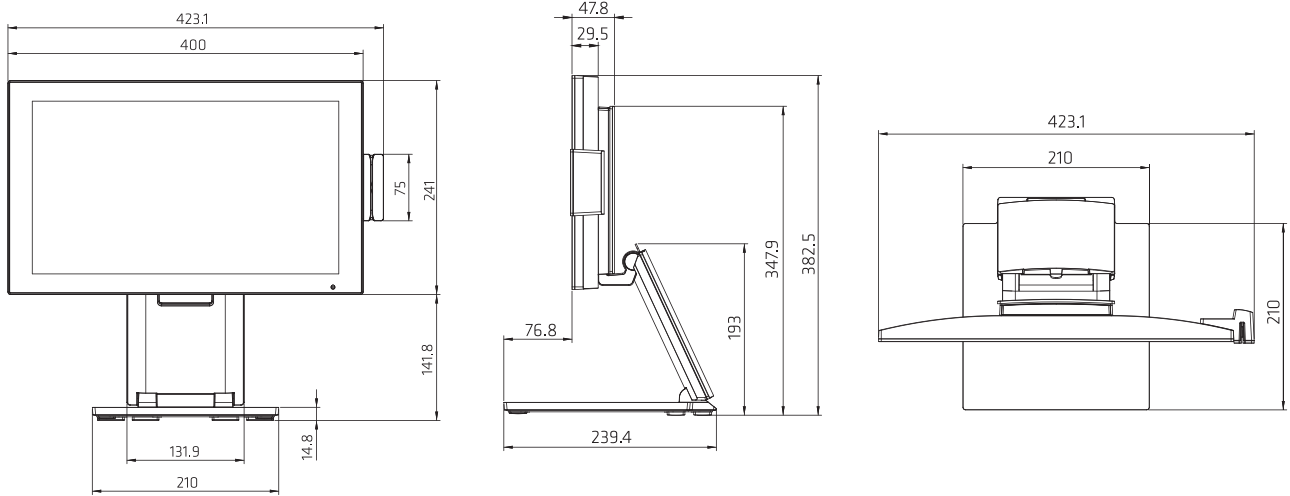

## I/O Interfaces

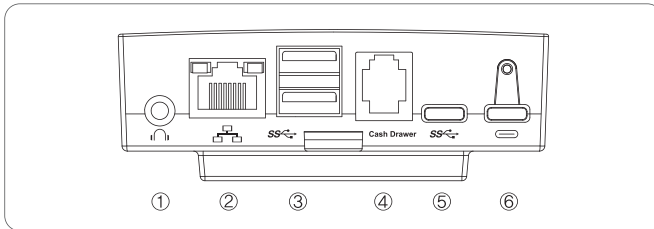

- ① AUDIO 0 UT
- ② LAN
- ③ USB 3.0 X 2
- ④ RJ - 11 X 1 (Cash Drawer)
- ⑤ USB C X 1
- ⑥ USB C X 1 (DC-IN)

## Key Features

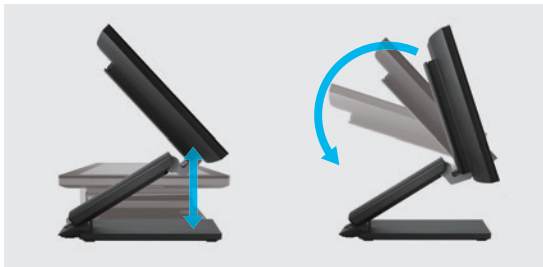

Adjustable Height & Viewing Angle



Swappable System Box



Full Aluminum Die-casting Cabinet

## Peripherals



2nd Display  
• 9.7", 13.3" LCD



Customer Display  
• VFD (2 Line x 20 Characters)



Card Reader  
• MSR, SCR

### KINGDOM OF BAHRAIN

Office 41 - Building 884 - Road 3618  
Block 436 - seef, Manama

+973 33771183  
+973 39999549

### KINGDOM SAUDI ARABIA

Aldossary Mall , Second Floor  
Al khobar, Kingdom Saudi Arabia

+966 138811050  
+966 591058811

### UAE, DUBAI

6th Floor , Concord Tower , Dubai  
Media City , UAE

+971 44549842  
+971 544453452